

Mechanical power clamping nut I Series MCA-S/MCA-T

simple, manual operating with handle fast infeed motion due to automatic change over

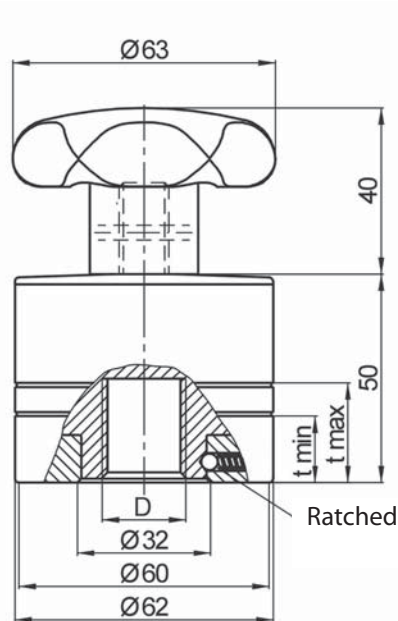

clamping nut MCA-S
with star grip

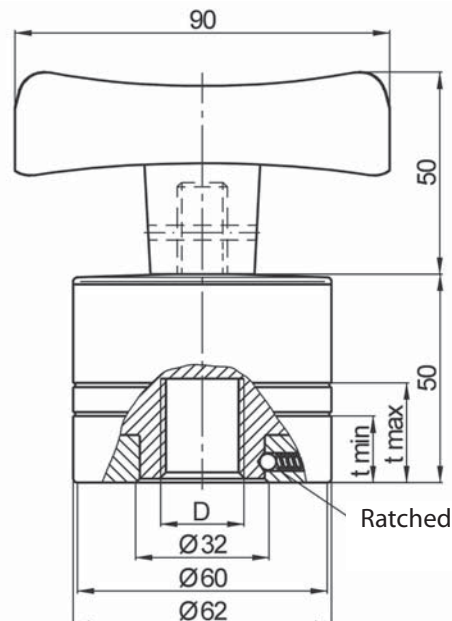

clamping nut MCA-T
with T-grip

Technical data and dimensions [mm]:
length dimensions according to DIN ISO 2768 mH

Series	nominal clamping force [kN]	thread	max static load [kN]	screw in depth		weight approx. [kg]
				t _{min}	t _{max}	
MCA-S	40	M 10	50	16	24	1,0
		M 12	70			
MCA-T		M 16	120			
		M 20	120			

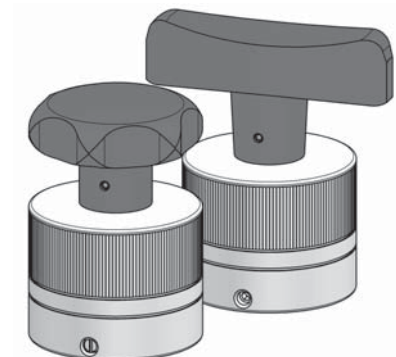

Notice:

Property class of threaded bolt should be at least Q10.9. Sizes of thread larger than M 16, should used a property class of Q 12.9, or the max. static load must be reduced. For optical control of actual screw-in depth of the T-bolt two grooves have been provided on the housing circumference matching t_{min} and t_{max}. When laying out the actual screw-in depth of the threaded bolt, the necessary stroke must be considered i. e. the max. specified screw-in depth must be reduced at least by amount the stroke.

Application example:

MCA-T-clamping nut for adjustment of test bench sliding table

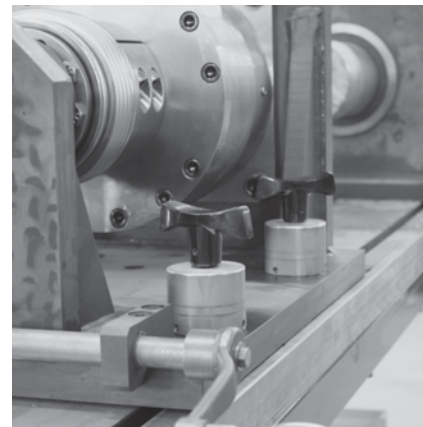

Ordering example: MCA-S - M 16 / MCA-T - M 20