

Eccentric block-type clamp I Series EBS

- flexible, sturdy and compact design
- simple handling - quick action clamp system
- high operating reliability by self-locking

With this mechanical eccentric block-type clamp "EBS" the user has a very compact and sturdy clamping element with high clamping forces and low tightening torques. To emphasize is the simple, manual operation (180° turn of the service hexagon), and the high operating reliability. The EBS - clamping element can be used for the manual tool clamping on presses and punches. Beyond this it can be used for plenty of clamping tasks in the entire field of mechanical engineering.

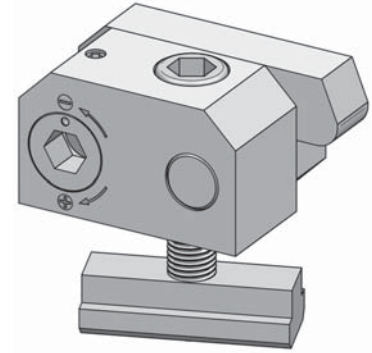

Technical data:

EBS Size	nominal clamping force [Nm]	max. tightening torque "SW1" [Nm]	max. static load [kN]	clamping range "h" * [mm]	weight approx. [kg]	T-slot DIN 650 m**	H min/max
20	20	40	40	0 - 31	1,8	18 22	18 / 24 22 / 29
40	40	75	80	0 - 51	3,6	22 28	22 / 29 28 / 38

* tolerance: max. ±0,2mm; greater clamping edge heights with distance plates are available on request.

** further T-slot dimensions on request

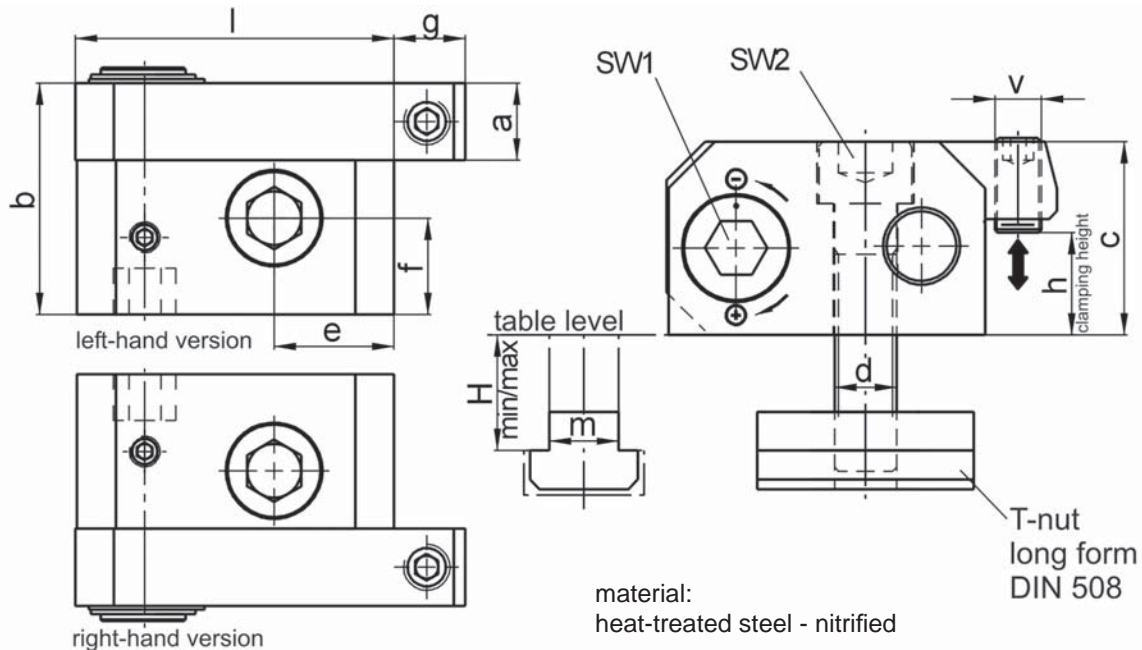

Dimensions [mm]: length dimensions according to DIN ISO 2768 cH

EBS	a	b	c	d (Q12.9)	e	f	g	L	SW 1 SW 2	V*
20	20	60	50	M 16	31	25	19	82	14	M 12
40	25	75	70	M 20	36	32	23	100	17	M 16

* alternative: bolt lever with setscrew and adjustment thread for variable clamping edge heights

Mark at the service hexagon

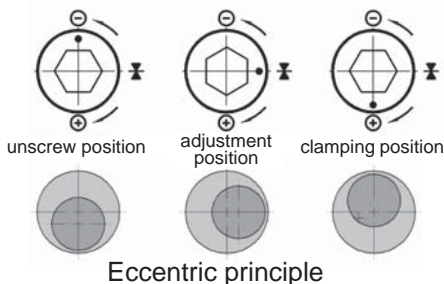

Ordering example: EBS 40 L - 30 - 22

Reihe _____
 Größe _____
 Linksausführung _____
 Spannhöhe "h" = 30 mm _____
 T- Nutgröße "m" = 22 mm (DIN 650) (m. T- Nutenstein) _____