

Clamping systems 3AX and 5AX

27669

Clamping systems 3AX-100 and 5AX-100



Type

- High clamping force (up to 42 kN) where needed
- Tension spindle immediately below workpiece support
- No expansion of chucks under load
- No torsional stress on machine table
- Extreme rigidity of system
- 3 or 8 mm clamping depth
- Interference edge-free 3 and/or 5-axis machining
- Any size of waf

Use

For clamping of workpiece on a 3 and/or 5 axis milling machine.

27669 301-302

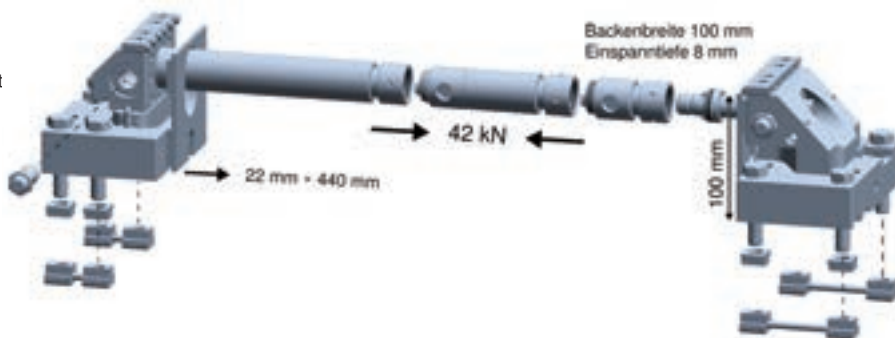

27669 303-304

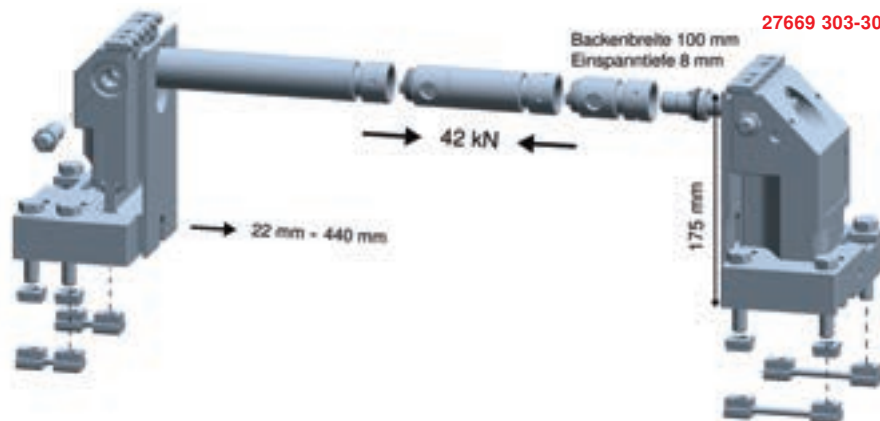

Type	for keyway mm	27669	...
3AX-100	14		301
3AX-100	18		302
5AX-100	14		303
5AX-100	18		304

Extension shaft with nut

Length mm	27669	...
60		305
120		306
240		307
480		308



Increase including suitable support strip

for tensioner	increase to mm	27669	...
3AX-100	125		309
3AX-100	150		310
5AX-100	200		311
5AX-100	225		312
5AX-100	250		313

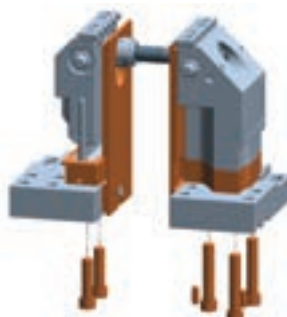

27669 309-313

27669 314

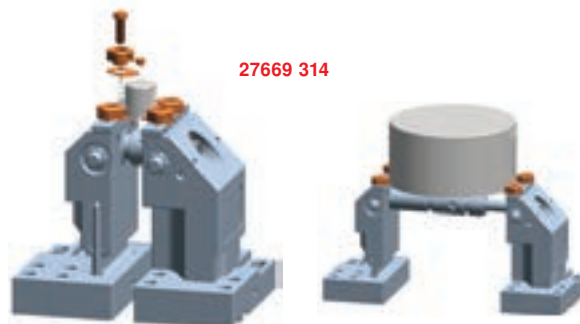

27669 315



Description	27669	...
Round clamping heads incl. pins, Retaining material and support		314

Description	27669	...
Hold-down chucks, smooth		315

Continuation ▶

Designation	for Tensioner	27669	...
Support strip 105 mm, Clamping depth 3 mm incl. 12 pins, Ring cutter 6 mm	3AX-100		316
Support strip 180 mm, Clamping depth 3 mm incl. 12 pins, Ring cutter 6 mm	5AX-100		317



Description	27669	...
Limit stop set pivotable		318

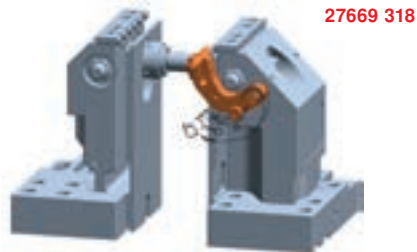

Description	27669	...
T-keyway plate 400 mm incl. mounting for Keyway width 14 mm		319
T-keyway plate 400 mm incl. mounting for Keyway width 18 mm		320

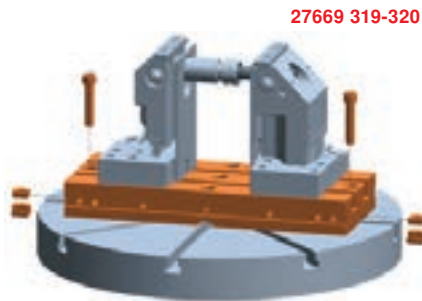

Description	27669	...
T-keyway plate 400 mm with NP journal bore		323

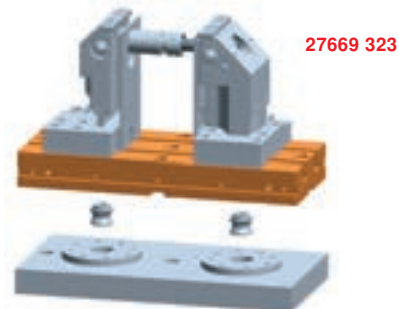

Description	27669	...
Pin smooth		324
Pin with ring cutter Ø 4 mm		325
Pin with ring cutter Ø 6 mm		326



Description	27669	...
Chuck jaws, blank		327

